

## DeLand Courtroom Technology

Courtrooms are set up with four flat panel monitors for ease of viewing throughout the courtroom. Two are in the center of the room, one in the corner, and one on the opposite wall of the Jury box, as seen below.



The courtroom is equipped to be in multiple room display modes. The Judge has control over the display mode.

- Standard - A static image of the 7<sup>th</sup> Judicial Circuit (As pictured above)
- Presentation – Allows prosecution, defense, or Wi-Fi users to display their devices on the monitors.
- Zoom – Allows participants to appear via Zoom in the courtroom.

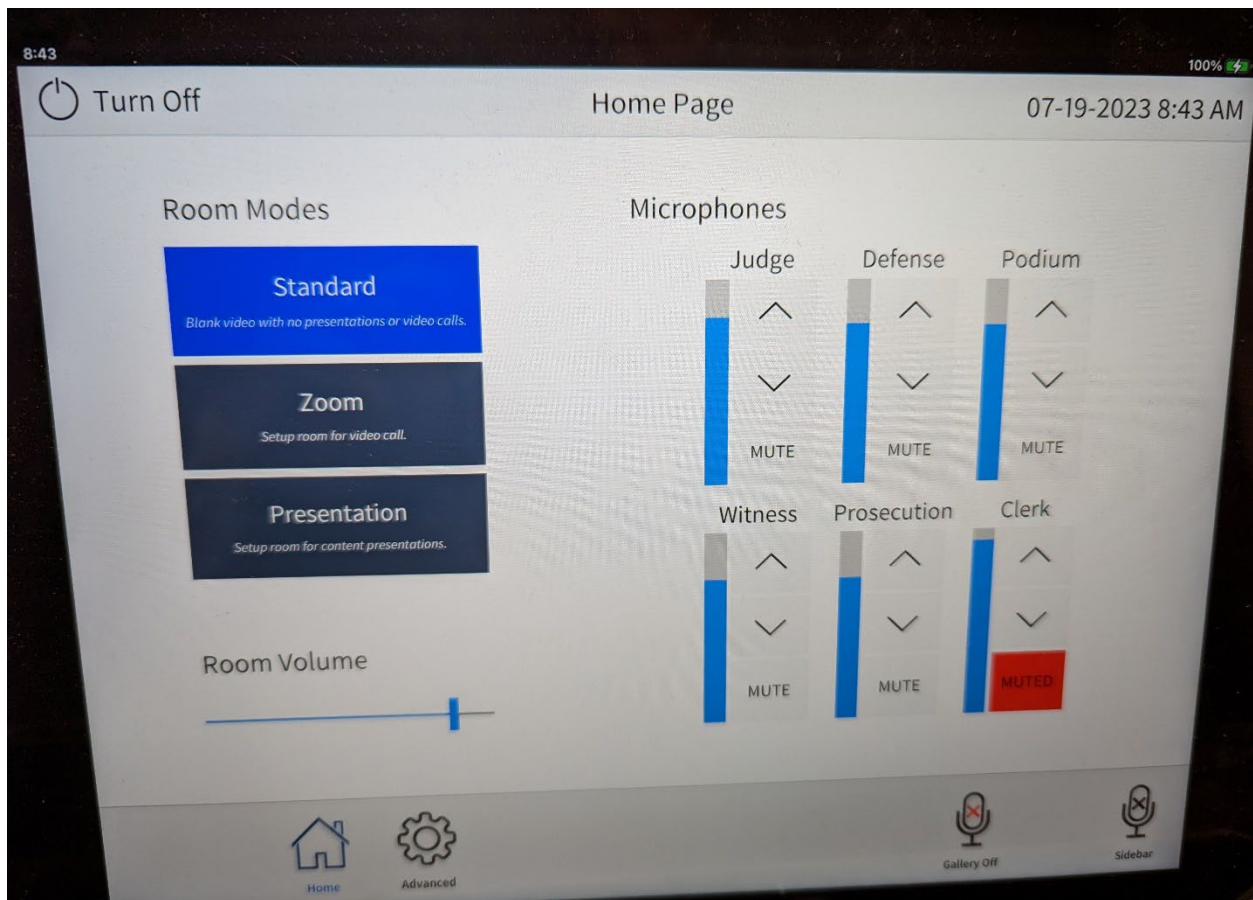

Two power receptacles with an HDMI connection are situated in the prosecution and defense tables for counsels to display their audio/video to the court. Users may also use Wi-Fi, but a hardwired connection via HDMI is strongly encouraged as all devices are not supported by Wi-Fi.

You will be responsible for supplying any additional adapters for your device.

### HDMI Connection



For display over Wi-Fi, you will need to connect to the “Clerks Office Public Internet”, and it is recommended to download the vSolution application in advance.

For the vSolution app, Click Here -> [vSolution App - WolfVision GmbH](#)

Please note that the Clerk's office provides public Wi-Fi as a courtesy to the public. Users should test their equipment before the hearings as Court Technology cannot support users' devices and public Wi-Fi.